

TruForce

EM Universal Testing Machine | TF-ETM106D | 1000kN

TruForce TF-ETM106D Series addresses the needs of standardized and routine testing, providing the user high quality at the most affordable price. The dual column testing systems with rugged structure are suited for tension and/or compression applications with load range requirements up to 1000kN. They are typically used for quality control and production testing.

Typical specimens: Metals, building components, large fasteners, composites, wood products

Environmental simulation: Environmental chamber and high temperature furnace

New Features:

- Robust guidance columns increase lateral stiffness and ensure linear crosshead travel. This results in accurate crosshead alignment thus reducing variability in measurement data and producing better overall accuracy
- Non-clutched drives, rated for full speed at maximum force
- Compact design saves lab space
- Wider test width

High Quality at affordable price

- Pre-loaded ball screws and heavy duty bearings assure long life with zero backlash as well as linear low force and through zero performance. The result is accurate and repeatable measurements that truly represent the specimen characteristics rather than load frame deficiencies
- Fully-protected lead screw covers provide longer life and greater operator protection
- Easy-to-clean aluminum column covers with chamfered corners to facilitate access to the test area. T-slots are built in for simple, convenient attachment and positioning of testing accessories
- High-speed, low vibration, world-class, maintenance-free, Japanese made AC servo motor and servo controller
- Photoelectrical encoder built in servo motor system is for position measurement of crosshead
- Built-in bidirectional load cell is assembled in the middle crosshead to prevent any collisions and simple to perform compression or tension tests
- Dual action over-travel limits on all frames provide the highest level of safety and meet all international standards
- Remote control keypad facilitates test operation
- DTC-500 controller provides high speed data acquisition with 8-CH A/D converting
- Full one-year warranty on parts



AC2012-ETM106D

Various frames to satisfy your test needs from low force to high force

Heavy duty load frame 200/300kN is available with single and dual test space, saving time and labor to change fixtures when frequently performing tension and compression/flexure tests.

Standard equipped with wedge action tensile grip, and optional hydraulic tensile grip is available.

Heavy duty load frame 500/600kN is dual test space equipped with hydraulic tensile grip for large and high strength specimen

Heavy duty load frame 1000kN with SINGLE test space equipped with hydraulic tensile grip for large

Full complement of test accessories

Extensive range of accessories to meet test requirements in almost any application or industry: plastics, metals, biomedical, composites, elastomers, components, automotive, aerospace, textiles, and more.

- Tension grip
- Peel/tear fixture
- Compression fixture
- Flexure fixture
- Film COF test fixture
- S type load cells: 10N~50kN
- Long travel extensometer
- Clip-on extensometer
- Auto-extensometer
- Environmental chamber
- Furnace
- T-slot table
- Others



Machine dimension: ETM106D

Test space	Frame type	Width x Depth x Height A x B x C (mm)	Crosshead travel H (mm)	Test width W (mm)
Single space	Standard	1500x820x3540	1000	900

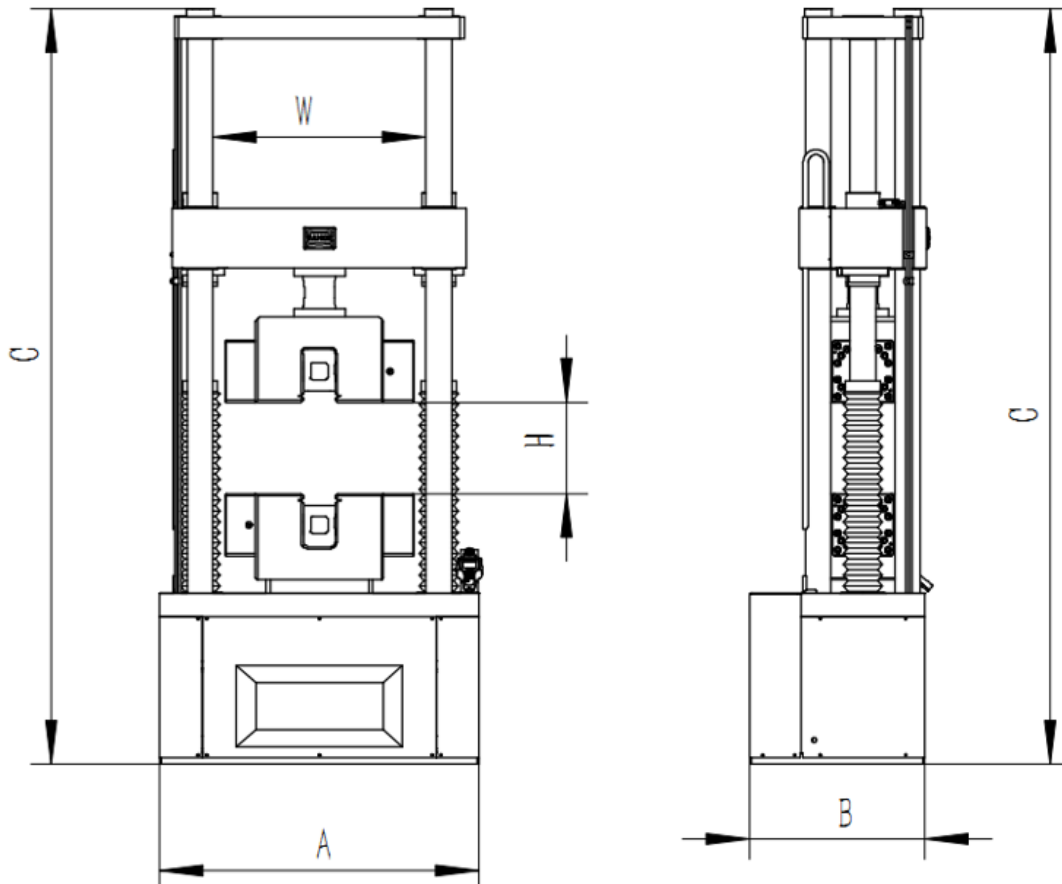

Specifications:

Model	TF-ETM106
Type	Type D
Capacity (kN)	1000
Calibration standard	ISO 7500, Class 0.5
Force range	0.4 ~ 100%FS
Force accuracy	±0.5% of reading
Force resolution	1/500000FS
Position accuracy	±0.50% of reading
Position resolution (µm)	0.05
Crosshead speed (mm/min)	0.001—200mm/min
Crosshead speed accuracy	within ±0.5% of set speed
Crosshead travel (mm)	1000
Test width (mm)	900
Dimension (mm)	1500x800x3540
Power requirements	3-phase, 415V±10%, 50/60Hz
Power consumption	12kW
Weight (kg)	8000

Two steps to start testing: select a project, press start

This software features a large, growing host of pre-packaged test methods to help you quickly and efficiently meet the requirements of global test standards such as ASTM, ISO, DIN, EN, BS, and more. Selected by an operator at runtime, these methods are crafted to meet the specific test flow, analysis and reporting requirements of industry standards across a range of specimen and test types. Pre-packaged test methods are available in a wide selection of bundled sets, including: Polymers & Plastics, Metals, Construction Materials, Biomedical Products, Paper Products, Adhesives, foam, textiles and more.

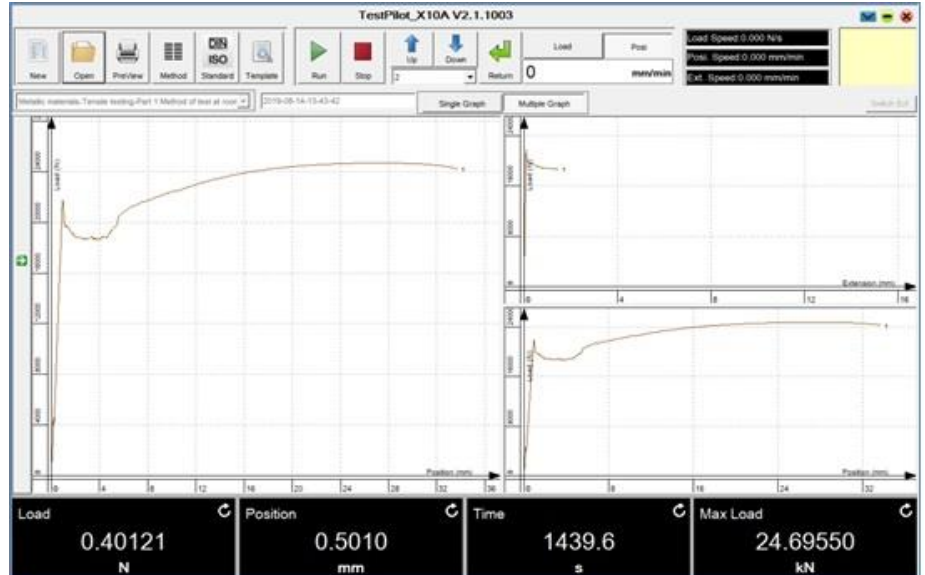

- Versatile, easy-to-use TruTest software with a large and growing library of standards-compliant test methods (ASTM, ISO, DIN, EN, BS, and more)
- Modular design permits easy upgrading
- Plenty of test standards are built in the library of the software for routine tests.
- User configured report: user can preset report template and include necessary information, like company information, statistics, and etc. Test report can export to Excel or Word.
- Powerful graphic function: real time display curves, like displacement-load, stress-strain, displacement-time, load-times, and others
- Powerful analysis function can calculate typical value and display on the curve, like Fm, ReL, ReH, Rp.
- Measurement unit: Users can select SI, or others, like N, kN, kgf, lbf, MPa, and so on, user can define the unit by themselves using formula.



Modular design is simple for operation and upgrading